

FORDHAM UNIVERSITY - TERM CONTRACT

BRONX, NEW YORK

Firm: MATTHEWS MOYA ARCHITECTS

FORDHAM UNIVERSITY - TERM CONTRACT

Under a three-year Term Contract with Fordham University we are involved in an array of building projects that re-introduces 'Collegiate Gothic' architecture to the Rose Hill Campus. This redefined style entails a modern interpretation of the scale, materiality and permanence of the historical precedents of the campus. These projects include a new softball stadium, renovations to Fordham's historic church, 'screen' designs to hide new mechanical equipment, and new facilities for the Custodial Department. In addition to which is our break-through design for a major expansion and renovation to the Student Center.

- *Projects that redefine a Collegiate Gothic campus*
- *Tight schedules with results*

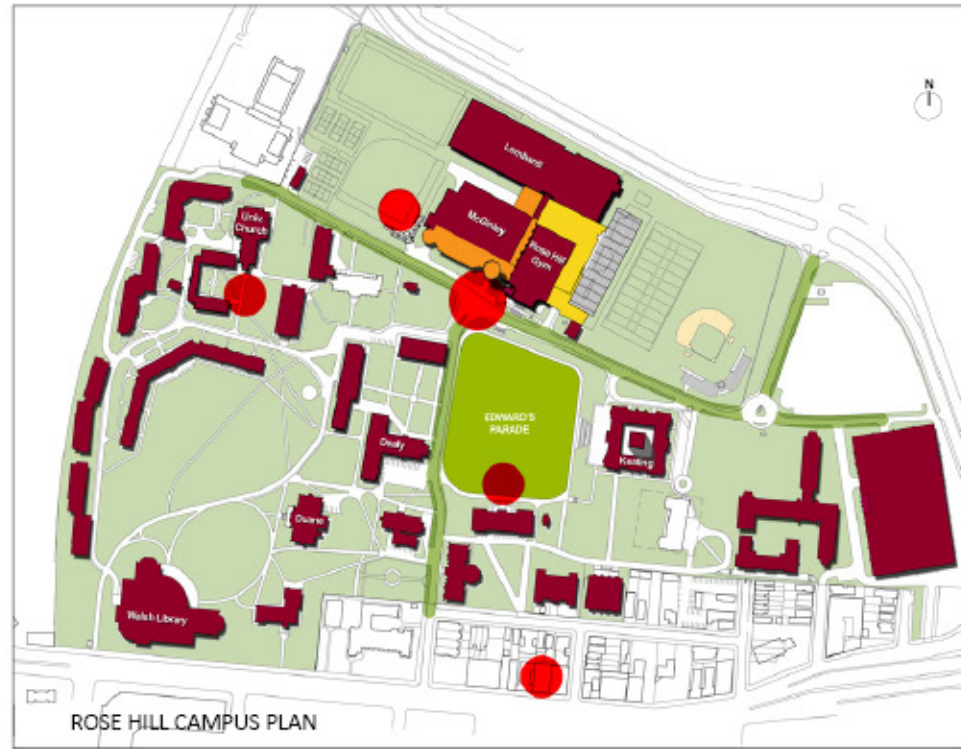

ROSE HILL CAMPUS
SITE: Bronx, NY

FREEMAN HALL

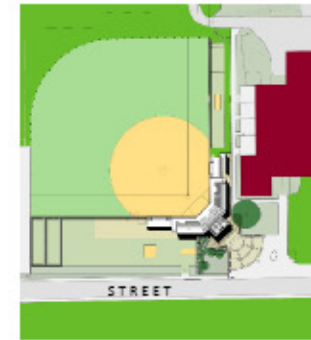

MURPHY FIELD SOFTBALL STADIUM

Fordham's new Murphy Field provides a state-of-the-art facility befitting to this Atlantic Conference Championship team. The 300-seat stadium is flanked by stone faced dug-outs. A two-story center 'block' contains restrooms and the press box in a limited existing site. Working with the existing wrought-iron gateway, the block's design frames Mr. Murphy's commemorative bronze bust with increasingly refined stonework gestures.



VIEW FROM STUDENT CENTER ENTRY



HISTORIC FORDHAM CHURCH

These renovations coordinate the incorporation of two new pipe organs, tower improvements and improved accessibility at Fordham’s historic church.

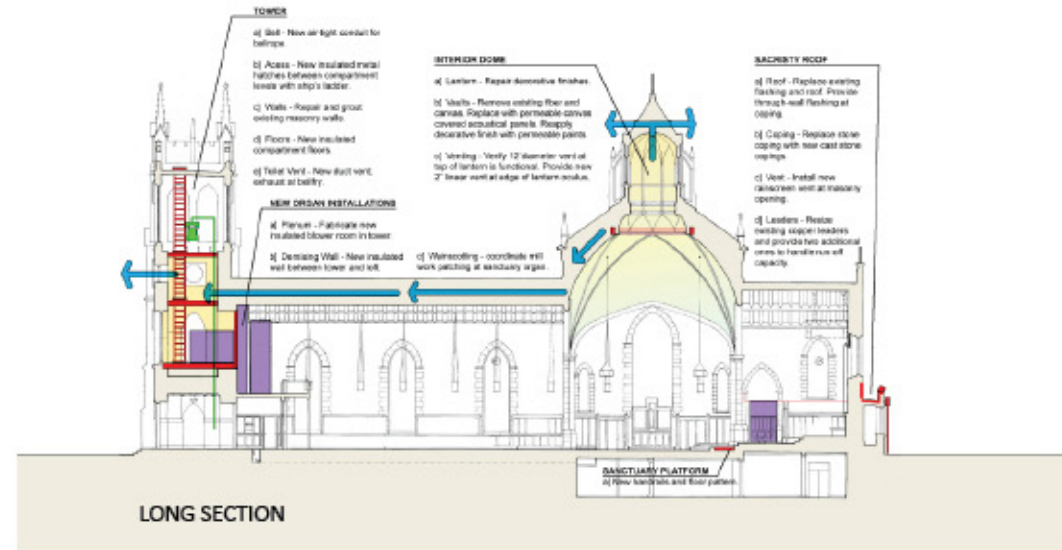

MCGINLEY STUDENT CENTER

This 60,000 SF expansion of the existing 1960’s Student Center nods to the neighboring Rose Hill Gym, the design re-affirms the Collegiate Gothic character of the campus at Edwards Parade Green, the heart of the university. The tower welcomes visitors to an interior multi-level arcade animated with a diversity of student life activities. These are organized, along-side the gym with a naturally-lit green wall that vitalizes even the lowest level student areas. The expansion program entails a range of collaborative work and recreational spaces that engage students and contributes to the engaged campus community.

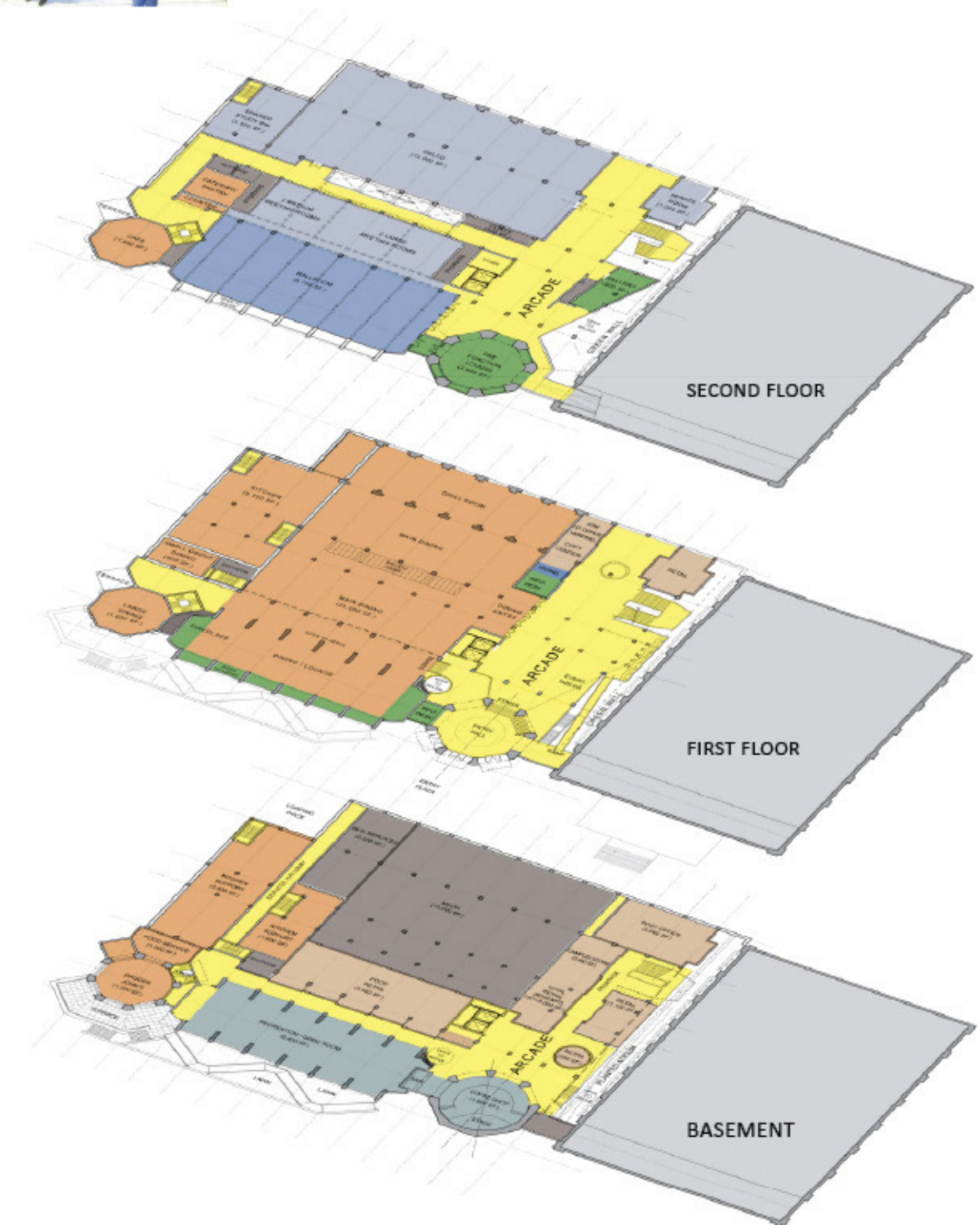

CUSTODIAL BUILDING

This extensive renovation of a commercial building provides facilities for staff members of the Custodial Department. The south-facing terra-cotta rain-screen façade fits in the existing brick-faced streetscape and deftly provides both sun-shading and security protection.





VIEW OF ARCADE



BALLROOM ENTRY



CONSTITUTION ROW FACADE